

Quick Guide - DC9270D

1

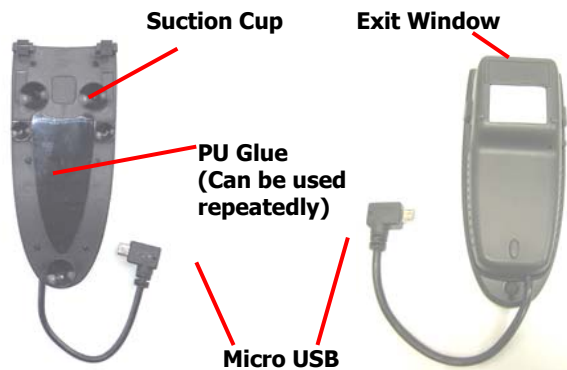

Connect to micro USB port of OTG device

2



Indicator (LED)

Li-Ion Battery

3

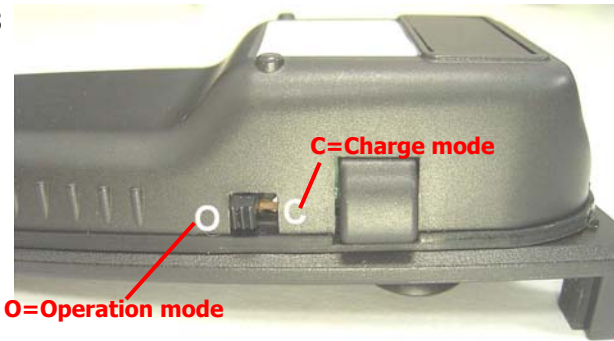

O=Operation mode

- * Before you use scanner, please switch to "C" for battery charge for 3~4 hours.
- * Under "C mode", you can raise/lower soft-keyboard easily. (For USB HID only)

4

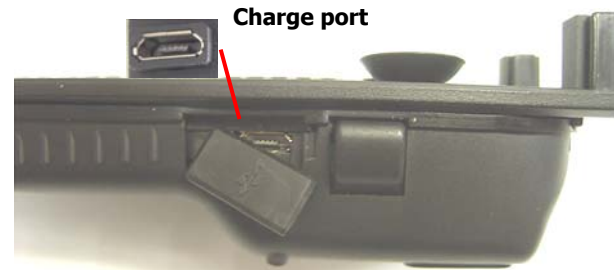

Charge port

DC9270D is with Li-Ion battery inside. When in charging, please use the original power adaptor of OTG device (recommend). Through it, it charges both OTG device and DC9270D internal battery at the same time. When in low battery (Red LED flashing), please charge it immediately.

LED Indicator Information

Green LED OFF	Full charged (Charge mode)
Green LED ON	Charging (Charge mode)
Red LED Flashing	Low battery (Operation mode)

Attention: Under "Operation mode" please do not charging, otherwise the OTG device's battery will be charging back to DC9270D's battery.

5

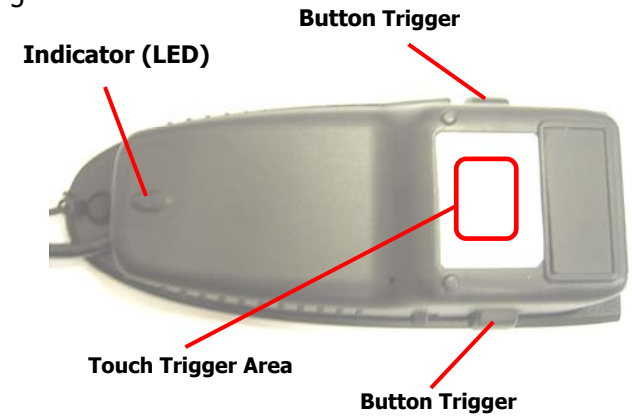

The touch sensor area is around the central area. There are 2 button triggers on the right and left side. Please check the above drawing for your reference.



Installation

Before using scanner, please make sure that the OTG device is fully charged.

- Under USB HID interface
 - ** When plugged into OTG device, it will be recognized and begin to scan the barcode.
- Under USB Serial interface
 - ** Please install PL-2303 driver into your OTG device first. PL-2303 driver can be downloaded from Google Play
 - ** Connect scanner to your OTG device, then, you can know which serial port scanner connects to.
 - ** The data you scan will be sent to serial port and your APP can get the data from serial port directly.

Reset Configuration to Defaults

If you are unsure of the scanner configuration or have scanned the incorrect codes, please scan the "Default" barcode. This will reset the scanner to its factory defaults. (scan from A1 to A6 for USB HID, B1 for HID)



Note: Please install PL-2303 driver for USB Serial.

Keyboard Language (For USB HID only)

Scan the appropriate country code as below to program the keyboard layout for your country or language. As a general rule, the following characters are supported, but need special care for countries other than the United States:

@ | \$ # { } [] = / ' \ < > ~



USA
(Original setting)



Norway



Germany



Sweden



Denmark



Switzerland



Italian



France



Vietnam



Spain



Portugal



Hungary

Barcode Configuration Method:

Please follow the below 4 steps to complete the "Symbologies Enable" or "Symbologies Disable"

1. Start Configuration
2. Choose one of 1D symbologies
3. Enable setting: scan Enable-1, then Enable-2
Disable setting: scan Disable-1, then Disable-2
4. End Configuration

Start Configuration



1D Symbologies – 1



Barcode Configuration Method:

Please follow the below 4 steps to complete the "Symbologies Enable" or "Symbologies Disable"

1. Start Configuration
2. Choose one of 1D symbologies
3. Enable setting: scan Enable-1, then Enable-2
Disable setting: scan Disable-1, then Disable-2
4. End Configuration

Start Configuration



1D Symbologies – 2

Code 93



Code 11



MSI/Plessey



UK/Plessey



Codabar



Code 128

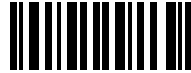

UCC/EAN 128



ISBT 128



1D Symbologies – 3

**Code 39
(Code 32)**

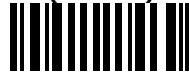

China Post



**GS1 DataBar
Limited**



**Interleaved
2 of 5**



GS1 DataBar



**GS1 DataBar
Expanded**



Enable-1



Enable-2

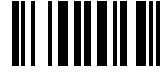

Disable-1



Disable-2



End Configuration



- Information in this document is subject to change without notice.
- For more information, please visit:
www.riotec.com.tw